

1 **Supplemental Information**
2 **for**
3 **904-565 Oil Filter Adaptor with Ports for 3 Sending Units**
4 **Miata 1990-2005**

5 **Contents of Kit**

6 1a Adaptor, polished aluminum

7
8 1b O-ring seal

9
10 1c Oil filter nipple (20 mm x 1.5)
11 *Used to secure the adaptor to the*
12 *existing oil filter nipple.*

13
14 1d Three ports for sending units

15
16 1e Plugs for unused sending unit ports

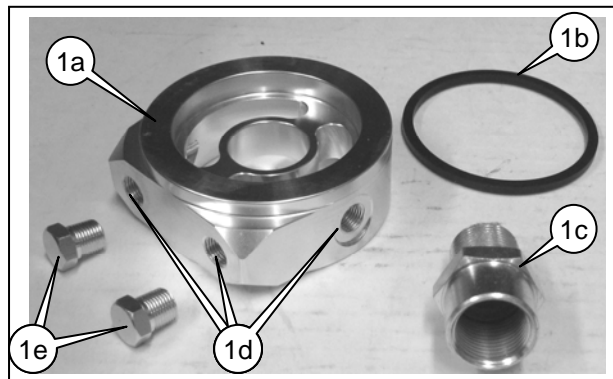

17
18
19 *A perfect solution for anyone that needs additional connections for gauge sending units.*

20
21 *This adaptor has three ports for sending units. All three ports will accept sending units with American 1/8"*
22 *NPT (27 TPI) thread or metric taper M10 x 1.0 threads.*

23
24 *This adaptor fits on all Mazda® MX-5 NA and NB vehicles from 1990 to 2005.*

25
26 *Machined from aluminum, the adaptor is highly polished and the package includes the o-ring seal, the oil*
27 *filter nipple, and tapered plugs for two of the three sending unit ports.*

28
29 *Uses the stock type Mazda oil filter. We suggest ordering a 900-950 (genuine Mazda) or a 900-951*
30 *(aftermarket) oil filter.*

31
32
33
34
35
36
37
38
39
40
41 *Although every effort has been made to ensure the accuracy and clarity of this information, errors and/or*
42 *omissions on our part are almost inevitable. Any suggestions that you may have that will improve the*
43 *information (especially detailed installation notes) are welcome. Please use the simple email form on the*
"Contact Us" page on the Moss website: <http://www.mossmotors.com/AboutMoss/ContactUs.aspx>
If you prefer, you may call our Technical Services Department at 805-681-3411. So many people call us for
help that we are often not able to answer the calls as fast as we'd like, and you may be asked to leave a
message. We apologize in advance for the inconvenience. We will get back to you within 2 business days.



Moss Motors, Ltd.

440 Rutherford Street, Goleta, California 93117
In the US & Canada Toll Free (800) 667-7872 FAX (805) 692-2510 (805) 681-3400

Moss Europe Ltd.

Hampton Farm Industrial Estate, Hampton Road West, Hanworth Middlesex, TW13 6DB
In the UK: 020-8867-2020 FAX:- 020-8867-2030