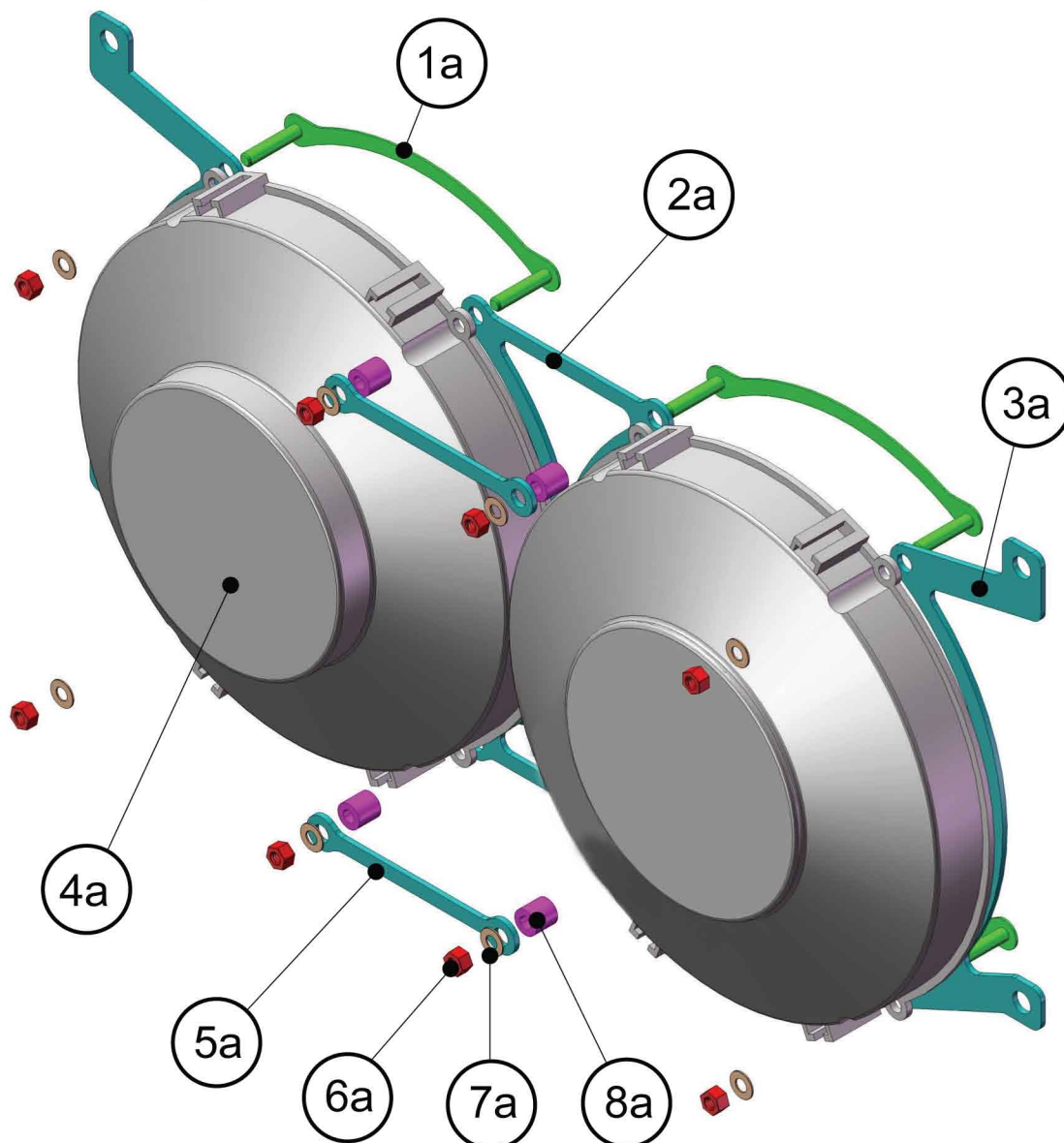

Parts List

- 1a Flush mounts (4off)
- 2a Central mounting bracket (1off)
- 3a Side mounting bracket (2off)
- 4a Cooling fan (2off)
- 5a Central brace (2off)
- 6a M6 nut (8off)
- 7a 6mm washer (8off)
- 8a Nylon spacer (4off)

Fig.5**Fig.6 Wiring twin cooling fans in parallel**